

**TSM's** StainlessConnect component system offers wall mounting (Series 300) and floor mounting (Series 500 and 550). Each series has interchangeable components for flexibility and maximum control of measurements, including corners (however, Series 300 and 500/550 are not interchangeable in 1½" O.D. components.)

## StainlessConnect for Walls (Series 300)

**TECH DATA**

- Material: Stainless steel type 304 (18-8) satin finish.
- Tubing: 1½" O.D. x 18 gauge (38x1.2mm) or 1.9" O.D. x 16 gauge (48 x 1.7mm) with ends turned 90° by mandrel bending and heliarc welded to flanges to form a single structural unit. Wall clearance is 1½" (38mm) to meet building codes.
- Connections: Assembly of components at jobsite is with internal dowels and adhesive or welding.
- Flanges Complying With 1½" Wall Clearance:
  - R-3 Exposed Screw, 3" x 8 gauge (76x2.1mm). Three ¼" (6mm) mounting holes per flange. *Shown with 304A*
  - R-1 Exposed Screw, 3" x 14 gauge (76x9mm). Three ¼" (6mm) mounting holes per flange. *Shown with 304U*
  - CS-1 Concealed Screw, 3" x 14 gauge (76x1.9mm) base and 20 gauge cover (0.9mm), snap-lock design. Three ¼" (6mm) mounting holes per flange. *Shown with 305T2R*
  - SF-6 Exposed Screw, 4" (102mm) square x ¼" thick (6mm). Four 3/8" (9.5mm) mounting holes per flange. *See photo on page 6*
- Universal Brackets with 2½" Wall Clearance (Fit 1½" & 1.9" O.D.):
  - 304R Self-Aligning Bracket is installed with one 3/8"-16 hanger bolt through the 3" round wall flange center (76mm).
  - 304E Extruded Wall Bracket is installed with one 3/8" hex head lag screw through the 2" wide base (51mm).
  - 304C Cast Wall Bracket is installed with one 3/8"-16 hanger bolt through the 3" round wall flange center (76mm).

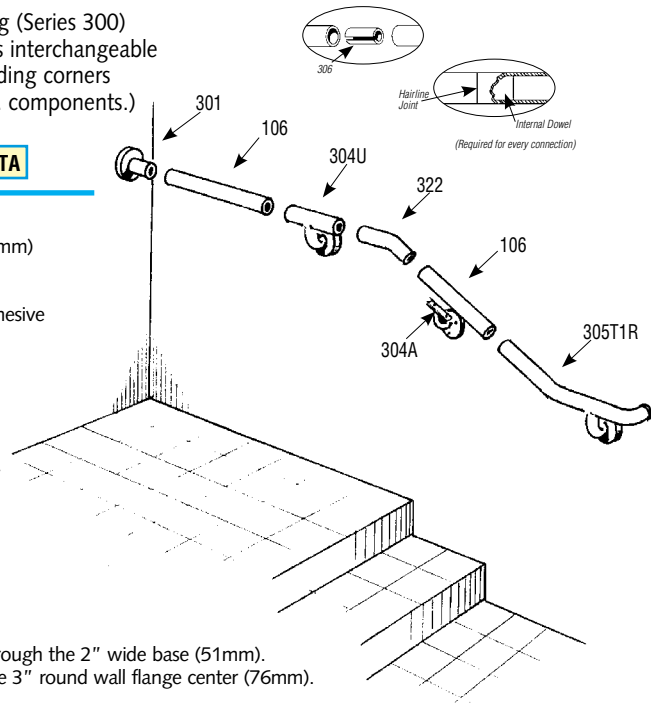

### Universal Brackets with 2½" Wall Clearance (Fit 1½" & 1.9" O.D.)

	1½" O.D. (38mm) R-3 Exposed Screw 8 ga. (4.2mm) Flanges	1½" O.D. (38mm) CS-1 Concealed Screw 14 ga. (2.1mm) Flanges	1.9" O.D. (48mm) R-3 Exposed Screw 8 ga. (4.2mm) Flanges	1.9" O.D. (48mm) SF-6 Exposed Screw ¼" Thick Flanges
<b>301 End Wall Bracket</b> Terminates rail into side wall.	H-301/R-3	H-301/CS-1	N/A	T-301/SF-6
<b>301/SLEV End Wall Bracket, Sleeved</b> Terminates rail into side wall.	H-301/SLEV/R-3	H-301/SLEV/CS-1	N/A	T-301/SLEV/SF-6
<b>302 Return Wall Bracket</b> Terminates rail with a sidewall return.	H-302/R-3	H-302/CS-1	N/A	T-302/SF-6
<b>303 90° Elbow</b> Forms inside or outside corner.	H-303	H-303	T-303	T-303
<b>304A Underslung Support with Saddle</b> Support is ½" rod (13mm). Attaches to tubing with set screws provided by manufacturer. Recommended spacing maximum 60" (1524mm) on center.	H-304A/R-3	N/A	T-304A/R-3	N/A
<b>304T Underslung Support with Saddle</b> Support is 1" O.D. tubing (25mm). Attaches to tubing with set screws provided by manufacturer. Recommended spacing maximum 60" (1524mm) on center.	H-304T/R-3	H-304T/CS-1	T-304T/R-3	T-304T/SF-6

<b>305TL</b>	
<b>305TR</b>	
<b>305T1L</b>	
<b>305T2L</b>	
<b>305T1R</b>	
<b>305T2R</b>	
<b>305U</b>	
<b>306</b>	
<b>307</b>	
<b>308</b>	
<b>309</b>	
<b>309P</b>	
<b>310</b>	
<b>322</b>	

	1½" O.D. (38mm) R-3 Exposed Screw 8 ga. (4.2mm) Flanges	1½" O.D. (38mm) CS-1 Concealed Screw 14 ga. (2.1mm) Flanges	1.9" O.D. (48mm) R-3 Exposed Screw 8 ga. (4.2mm) Flanges	1.9" O.D. (48mm) SF-6 Exposed Screw ¼" Thick Flanges
<b>305TL Wall Return Without Support, LH</b> Returns terminate end of rail to within ¼" (6.4mm) of side wall with 309P press fit into railing to enhance appearance.	H-305TL	H-305TL	T-305TL	T-305TL
<b>305TR Wall Return Without Support, RH</b> Same as 305TL.	H-305TR	H-305TR	T-305TR	T-305TR
<b>305T1L Wall Return With Support, LH</b> Same as 305TL.	H-305T1L/R-3	H-305T1L/CS-1	T-305T1L/R-3	T-305T1L/SF-6
<b>305T2L Wall Return With Support, LH</b> Same as 305TL.	H-305T2L/R-3	H-305T2L/CS-1	T-305T2L/R-3	T-305T2L/SF-6
<b>305T1R Wall Return With Support, RH</b> Same as 305TL.	H-305T1R/R-3	H-305T1R/CS-1	T-305T1R/R-3	T-305T1R/SF-6
<b>305T2R Wall Return With Support, RH</b> Same as 305TL.	H-305T2R/R-3	H-305T2R/CS-1	T-305T2R/R-3	T-305T2R/SF-6
<b>305U Underslung Support Return Wall Bracket</b> Same as 305TL.	H-305U/R-3	H-305U/CS-1	T-305U/R-3	T-305U/SF-6
<b>306 Internal Dowel</b> Used to connect component pieces together; one required for every hairline joint. Adhesive sealant supplied.	H-306	H-306	T-306	T-306
<b>307 Tee Connector</b> Connects three component pieces, one perpendicular, two horizontal.	H-307	H-307	T-307	T-307
<b>308 Outside Sleeve</b> Provides attractive covering for connecting seams as well as supplying added strength to connection.	H-308	H-308	T-308	T-308
<b>309 End Cap, Stainless Steel</b> Spring action insert. Press fits into ends of tubing. T-309 fits only straight tubing; no curved ends.	H-309	H-309	T-309	T-309
<b>309P End Cap, Black Plastic</b> Heavy duty black Butyrate. Press fits into ends of tubing.	H-309P	H-309P	N/A	N/A
<b>310 Adjustable Slope Elbow</b> Patent pending design allows adjustment at the jobsite from 5° to 30°.	H-310	H-310	T-310	T-310
<b>322 5° Elbow</b> Allows adjustment for a 1:12 slope. Custom angles available.	H-322	H-322	T-322	T-322
<b>106 Straight Tubing</b> Standard length is 20' (6096mm). Smaller sizes can be custom cut.	H-106(49) 18 ga. (1.2mm)	H-106(49) 18 ga. (1.2mm)	T-106(65) 16 ga. (1.7mm)	T-106(65) 16 ga. (1.7mm)

\* As specified

A = 2¼" for 1½" (57&38mm)  
& 2½" for 1.9" (64&48mm)