

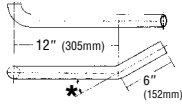

305TL

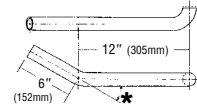

305TR



305T1L

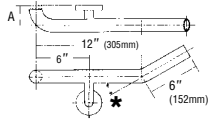

305T2L

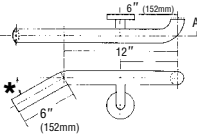

305T1R

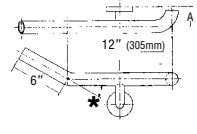

305T2R

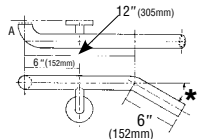

RH Shown
305U

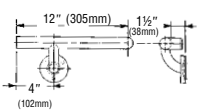

306

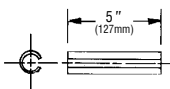

307

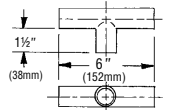

308

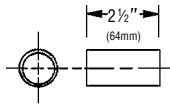

309



309P



310
Patent Pending

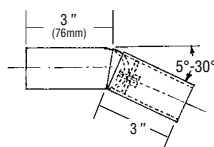

322

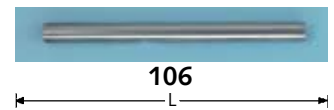
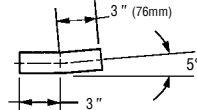

106

	1 1/2" O.D. (38mm) R-3 Exposed Screw 8 ga. (4.2mm) Flanges	1 1/2" O.D. (38mm) CS-1 Concealed Screw 14 ga. (2.1mm) Flanges	1.9" O.D. (48mm) R-3 Exposed Screw 8 ga. (4.2mm) Flanges	1.9" O.D. (48mm) SF-6 Exposed Screw 1/4" Thick Flanges
305TL Wall Return Without Support, LH Returns terminate end of rail to within 1/4" (6.4mm) of side wall with 309P press fit into railing to enhance appearance.	H-305TL	H-305TL	T-305TL	T-305TL
305TR Wall Return Without Support, RH Same as 305TL.	H-305TR	H-305TR	T-305TR	T-305TR
305T1L Wall Return With Support, LH Same as 305TL.	H-305T1L/R-3	H-305T1L/CS-1	T-305T1L/R-3	T-305T1L/SF-6
305T2L Wall Return With Support, LH Same as 305TL.	H-305T2L/R-3	H-305T2L/CS-1	T-305T2L/R-3	T-305T2L/SF-6
305T1R Wall Return With Support, RH Same as 305TL.	H-305T1R/R-3	H-305T1R/CS-1	T-305T1R/R-3	T-305T1R/SF-6
305T2R Wall Return With Support, RH Same as 305TL.	H-305T2R/R-3	H-305T2R/CS-1	T-305T2R/R-3	T-305T2R/SF-6
305U Underslung Support Return Wall Bracket Same as 305TL.	H-305U/R-3	H-305U/CS-1	T-305U/R-3	T-305U/SF-6
306 Internal Dowel Used to connect component pieces together; one required for every hairline joint. Adhesive sealant supplied.	H-306	H-306	T-306	T-306
307 Tee Connector Connects three component pieces, one perpendicular, two horizontal.	H-307	H-307	T-307	T-307
308 Outside Sleeve Provides attractive covering for connecting seams as well as supplying added strength to connection.	H-308	H-308	T-308	T-308
309 End Cap, Stainless Steel Spring action insert. Press fits into ends of tubing. T-309 fits only straight tubing; no curved ends.	H-309	H-309	T-309	T-309
309P End Cap, Black Plastic Heavy duty black Butyrate. Press fits into ends of tubing.	H-309P	H-309P	N/A	N/A
310 Adjustable Slope Elbow Patent pending design allows adjustment at the jobsite from 5° to 30°.	H-310	H-310	T-310	T-310
322 5° Elbow Allows adjustment for a 1:12 slope. Custom angles available.	H-322	H-322	T-322	T-322
106 Straight Tubing Standard length is 20' (6096mm). Smaller sizes can be custom cut.	H-106(49) 18 ga. (1.2mm)	H-106(49) 18 ga. (1.2mm)	T-106(65) 16 ga. (1.7mm)	T-106(65) 16 ga. (1.7mm)

* As specified

A = 2 1/4" for 1 1/2" (57&38mm)
& 2 1/2" for 1.9" (64&48mm)